

Contours are in NGVD29. All other elevation data is in NAVD88. You will need to add 3.61 feet correction factor to contour elevation.

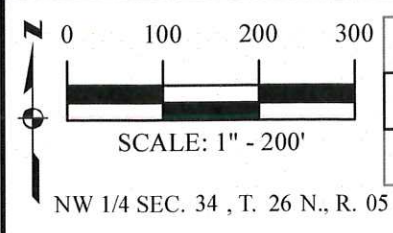

WASTEWATER SYSTEM MAP

			LEGEND			
City of Redmond	Manhole	●	Pipe	→	Under Construction MH	●
Joint Use	Drop Manhole	●	Force Main	→	Abandoned MH	●
King County	Cleanout	○		→	Side Sewer Cleanout	○
Other Agency		○		→	Grease Device	○
Private		○		→	Oil/Water Separator	○
				→	Under Construction Pipe	→
				→	Abandoned Pipe	→
				→	Side Sewer	→
				→	Hydrant	◇
				→	Pump Station	⬆



GRID NUMBER		
NA	2D4N	2D1N
NA	2D4S	2D1S
NA	2D3N	2D2N

2D4S
DATE: **2/12/2013**
FOR INFORMATION ONLY
THIS MAP AND RELATED DATA IS INTENDED TO ASSIST IN FIELD LOCATIONS AND IS NOT GUARANTEED TO BE ACCURATE. FIELD VERIFICATION IS REQUIRED FOR ALL DEVELOPMENT OR CONSTRUCTION PLANS.

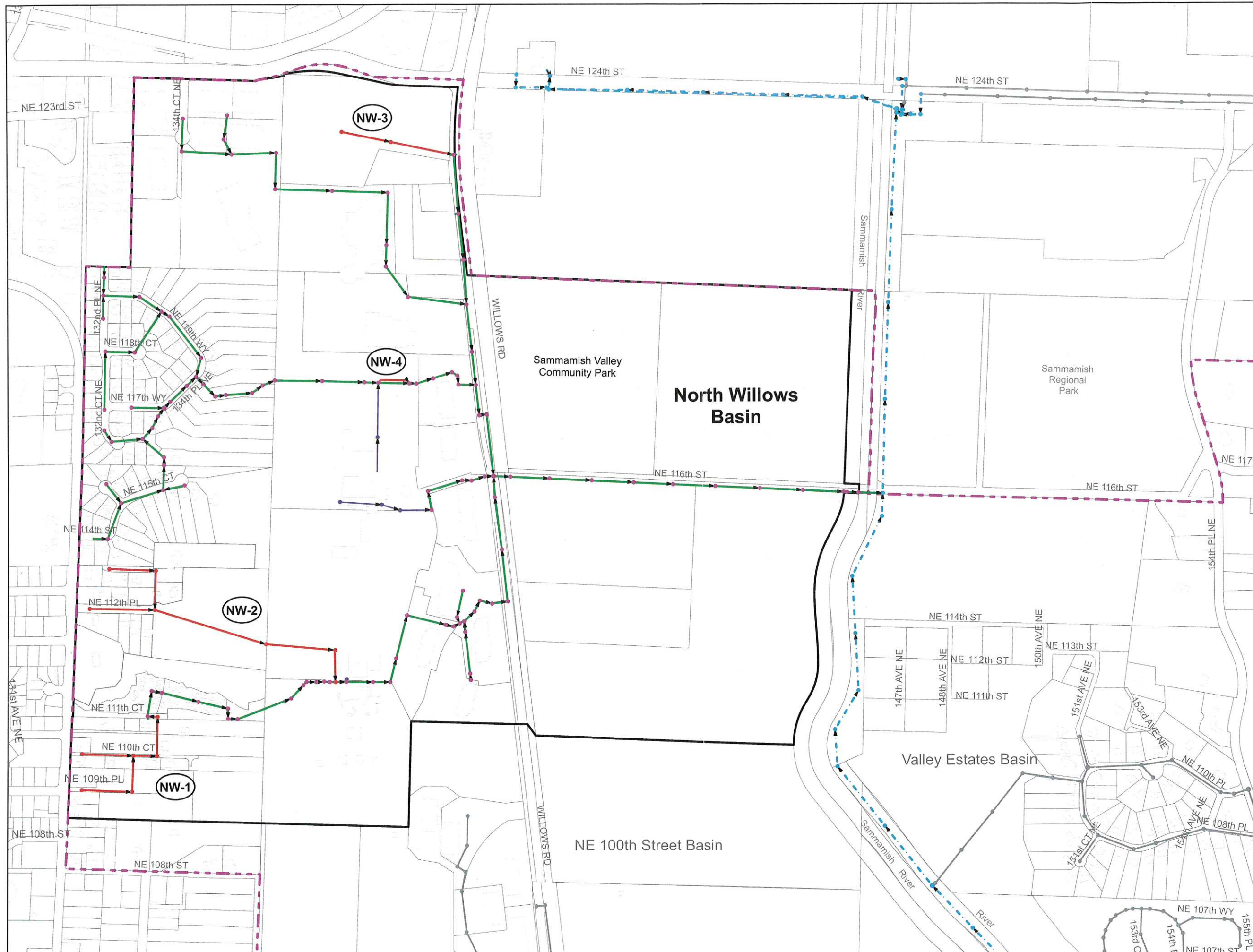

Legend

- City Limit
- Basin Service Area
- Neighborhood Sewer Area
- Parks and Open Space
- Grinder Pump Neighborhood

Gravity Pipe

- City of Redmond
- Private
- Under Construction
- Proposed
- Joint Use
- Other Agency
- King County

Force Main Pipe

- City of Redmond
- Private
- Under Construction
- Joint Use
- Other Agency
- King County

Pump Station

City of Redmond

0 300 600 900

Scale: 1" = 600'

Disclaimer: This map is created and maintained by the City of Redmond, for reference purposes only. The City makes no guarantee as to the accuracy or completeness of the features shown on this map.

Figure 4 - 17
North Willows Basin